

Accessory Descriptions:

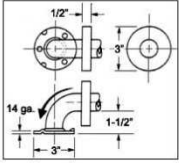

- Satin stainless steel finish grab bars. Meets ANSI A117.1 and ADA 2010 and exceeds all applicable federal load specifications when installed correctly.



- **ACXSYM1001** - Symmons Valve 15-1-2 port valve system, chrome trim with lever handle. A pressure-balancing shower valve maintains the pre-selected shower temperature by instantly and continually balancing the incoming hot and cold water pressures. Three mode wall/hand shower with flexible metal hose, in-line vacuum breaker, wall connection, and glide bar, chrome



- Fold down phenolic white bench style shower seat, white with stainless steel legs – ADA compliant. Meets ADA and exceeds all applicable federal load specifications when installed correctly.



- **KACXCURT** 74" H Heavy duty white vinyl shower curtain kit with rings. Curtain is staph, mildew, and fungus resistant with weights sewn into the bottom hem. **Strongly recommended for low threshold showers.**

- **KACXROD** CURTAIN ROD KIT: CONTAINS CURTAIN ROD AND AQA BRACKETS - ACX ROD & ACX ROD HOLD. May require field cut.



- **KTWSG** Ft Grey Water Stopper Kit. **Strongly recommended for low threshold Showers**



- **ACXDRAIN1000** "No Caulk Brass Drain for 2" PVC/ABS Connection; chrome screen/strainer



Soap dishes are solid cast filled polyester resin. They are surface mount for all shower models. Finish is gel coat color matched to shower - Install with adhesive and seal with caulk. Dimensions are 6.75" x 3.5" x 6.75".